

## ITI Mechanic Diesel 1st Year Module 7 Engine components

(1). What is the name of the drive?

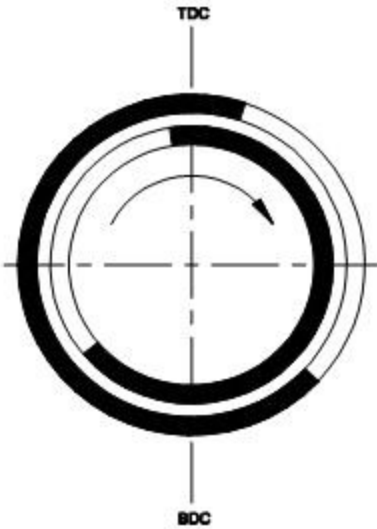

- (A) Belt drive
- (B) Chain drive
- (C) Rope drive
- (D) Gear drive

Correct Answer : A

(2). What is the term used to refer when both valves open position?

- (A) Lead
- (B) Lang
- (C) Overlap
- (D) Advance

Correct Answer : C

(3). Which bearing used in gear boxes?

- (A) Ball bearing
- (B) Roller bearing
- (C) Needle bearing
- (D) Taper roller bearing

Correct Answer : A

(4). Where the fly wheel is fitted in the engine?

- (A) Cam shaft
- (B) Crank shaft
- (C) Rocker arm shaft
- (D) Primary shaft

Correct Answer : B

(5). What is the cause of bearing corrosion?

- (A) Water mix with lubricant
- (B) Metal particle in lubricant
- (C) Insufficient lubrication
- (D) Less clearance

Correct Answer : A

(6). What is the name of the tool?

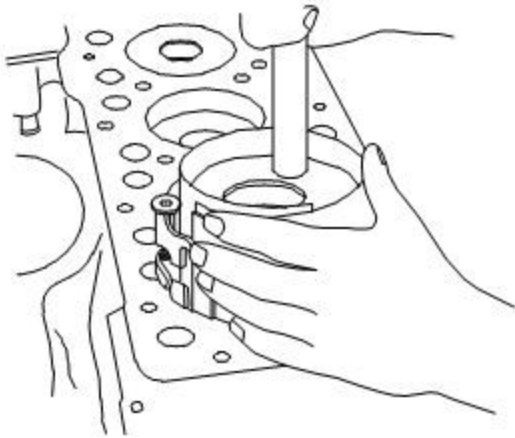

- (A) Torque wrench
- (B) Piston ring expander
- (C) Piston ring compressor
- (D) Circlip player

Correct Answer : C

(7). What is the name of the part marked as 'X'?

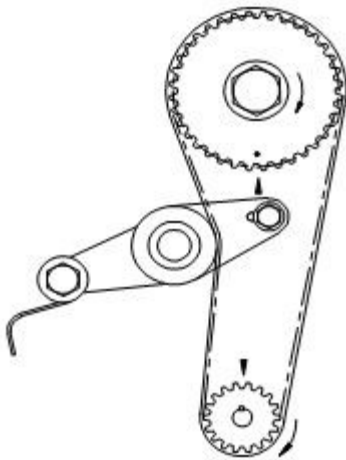

- (A) Gudgeon pin
- (B) King pin
- (C) Connecting rod

(D) Piston pin hole

Correct Answer : A

(8). What is the first step in removal method of fly wheel?

(A) Unlock the lock plate/wire

(B) Unscrew the fastening bolts

(C) Lock the fly wheel with wooden piece

(D) Remove the fly wheel ring

Correct Answer : A

(9). What is the term used to refer when a valve closes after BDC?

(A) Lead

(B) Advance

(C) Lag

(D) Over lap

Correct Answer : C

(10). What is the name of the valve mechanism?

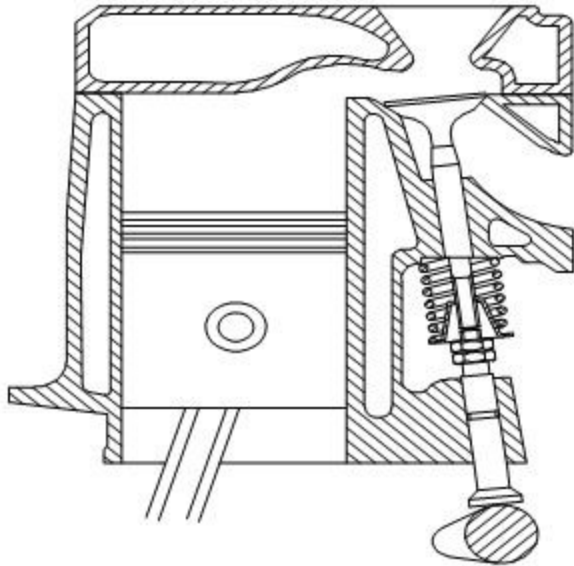

- (A) Over head valve
- (B) Side head valve
- (C) Rotary valve
- (D) Reed valve

Correct Answer : B

(11). What is the name the portion below the piston boss?

- (A) Land of the piston
- (B) Ring section of the piston
- (C) Crown of the piston
- (D) Skirt of the piston

Correct Answer : D

(12). What is the purpose of the fly wheel timing mark?

- (A) To coincide the gears
- (B) To set the engine timing
- (C) To set the F.I.P timing
- (D) To set the valve clearance

Correct Answer : B

(13). What is the name of piston ring?

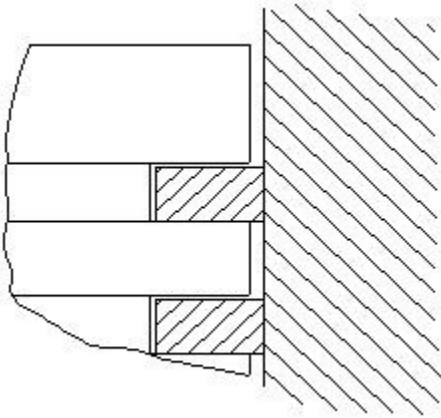

- (A) Rectangular ring
- (B) Tapper faced ring
- (C) Inside bevel ring
- (D) Key stone ring

Correct Answer : B

(14). What is the load taken by taper roller bearing?

- (A) Radial load
- (B) Axial load
- (C) Thrust load
- (D) Radial and axial load

Correct Answer : D

(15). What is the name of the diagram?

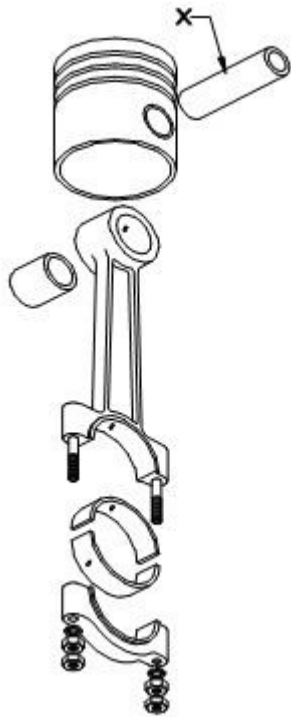

- (A) Injection timing
- (B) Port timing
- (C) Valve timing
- (D) Ignition timing

Correct Answer : C

(16). What is the material of cam shaft?

- (A) Forged alloy steel
- (B) Copper alloy
- (C) Aluminium alloy
- (D) Zinc alloy

Correct Answer : A

(17). What is the name of the bearing?

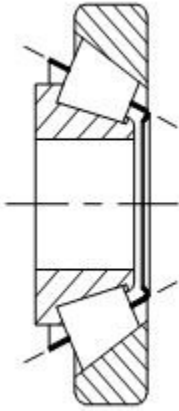

- (A) Ball bearing
- (B) Roller bearing
- (C) Needle bearing
- (D) Tapper roller bearing

Correct Answer : D

(18). What is the purpose of the timing chain?

- (A) To connect water pump pulley
- (B) To connect alternator
- (C) To connect crank and cam shaft gear
- (D) To connect A/C compressor

Correct Answer : C



(19). Which part of crank shaft is required hardening?

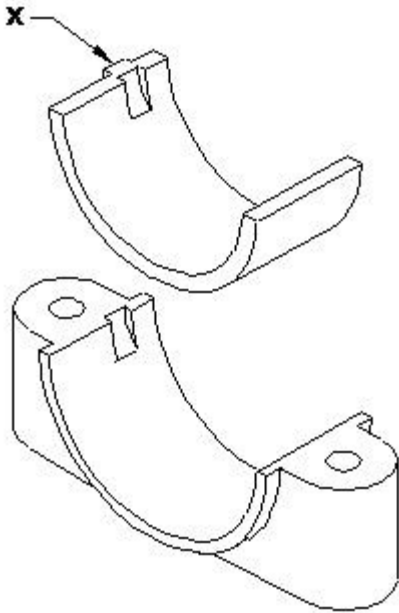

- (A) Piston pin
- (B) Piston boss
- (C) Connecting rod
- (D) Crank shaft journals

Correct Answer : D

(20). Which is the key element in converting reciprocating motion in to rotary motion?

- (A) Connecting rod
- (B) Gudgeon pin
- (C) King pin
- (D) Cam shaft

Correct Answer : A

(21). What is the speed ratio cam shaft to crank shaft?

- (A) Half
- (B) Equal
- (C) Double
- (D) Triple

Correct Answer : A

(22). What is the name of the part marked as 'x'?

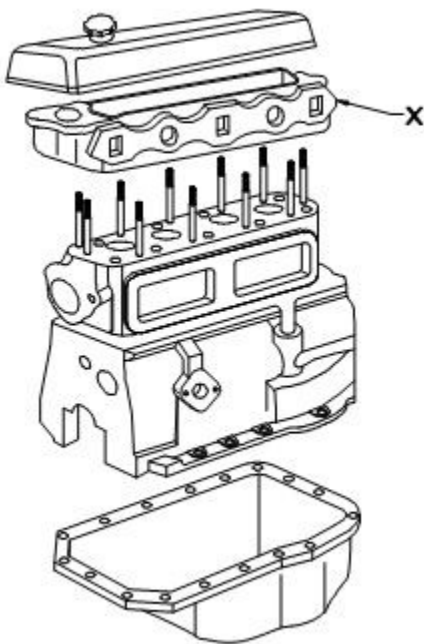

- (A) Valve door cover
- (B) Cylinder head
- (C) Engine block
- (D) Oil pan

Correct Answer : B

(23). Which is transferring energy for the piston to crankshaft?

- (A) Gudgeon pin

- (B) King pin
- (C) Connecting rod
- (D) Cam shaft

Correct Answer : C

(24). Which instrument is used to check the tappet clearance?

- (A) Depth gauge
- (B) Pitch gauge
- (C) Feeler gauge
- (D) Wire gauge

Correct Answer : C

(25). Which tool is required to remove the valves?

- (A) Torque wrench
- (B) Valve spring lifter
- (C) Box spanner
- (D) Scraper

Correct Answer : B

(26). What is the name of part marked as 'X'?

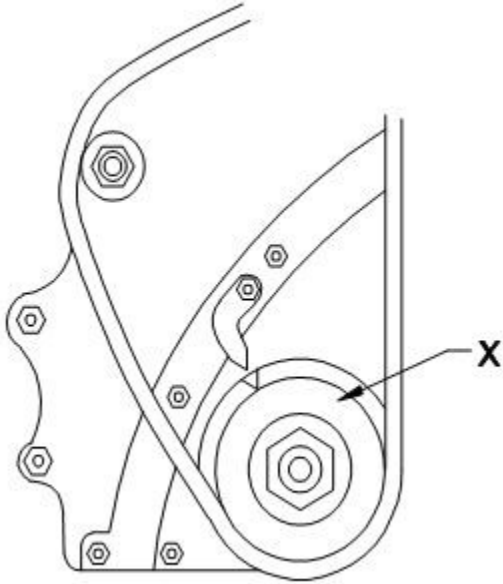

- (A) Alternator pulley
- (B) Water pump pulley
- (C) Crank shaft pulley
- (D) Dynamo pulley

Correct Answer : C

(27). What is the name of the part marked as 'x'?

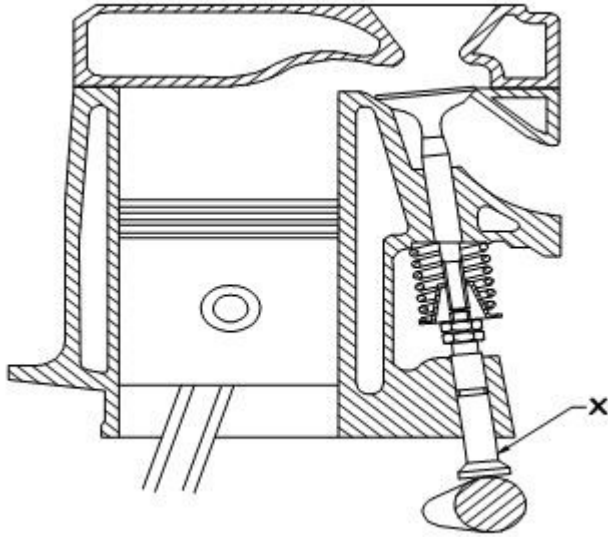

- (A) Cam lobe
- (B) Tappet
- (C) Valve seat
- (D) Rocker arm

Correct Answer : B

(28). Which is the drive source of a cam shaft?

- (A) Crank Shaft
- (B) Fly wheel
- (C) Self motor
- (D) Gear box

Correct Answer : A

(29). What is the name of the bearing?

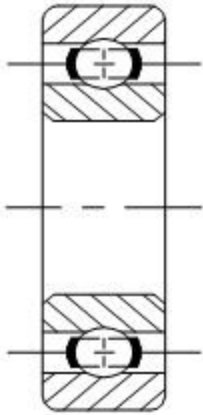

- (A) Ball bearing
- (B) Roller bearing
- (C) Needle bearing
- (D) Tappet roller bearing

Correct Answer : A

(30). What is the type of clutch?

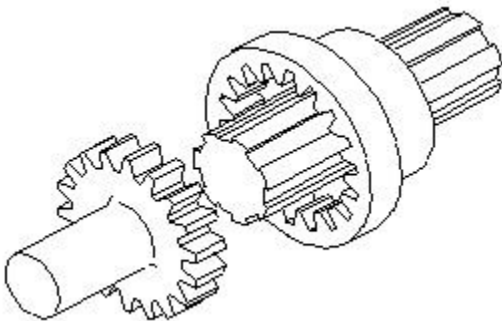

- (A) Cone clutch
- (B) Dog clutch
- (C) Dual clutch
- (D) Single plate clutch

Correct Answer : B

(31). Which valve allows one direction flow only?

- (A) Poppet valve
- (B) Rotary valve
- (C) Reed valve
- (D) Sleeve valve

Correct Answer : C

(32). What is the purpose of sodium filled in the Valve stem?

- (A) Quick cooling
- (B) Proper sealing
- (C) Proper lubricating
- (D) Keep the valve remain in open

Correct Answer : A

(33). What is the name of piston ring?

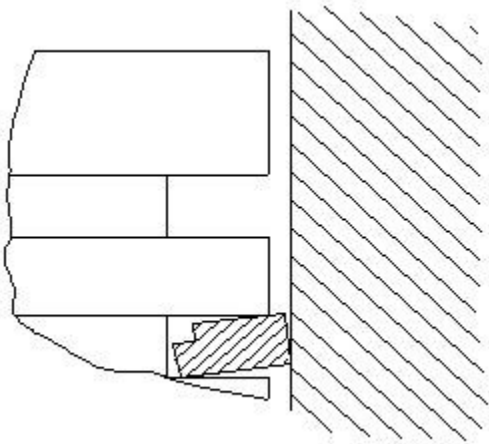

- (A) Rectangular ring
- (B) Tapper faced ring
- (C) Inside bevel ring
- (D) Key stone ring

Correct Answer : C

(34). Which measuring instrument used to check the fly wheel face out?

- (A) Dial indicator
- (B) Compression gauge
- (C) Outside micrometer
- (D) Feeler gauge

Correct Answer : A

(35). What is the name of the part marked as 'x'?

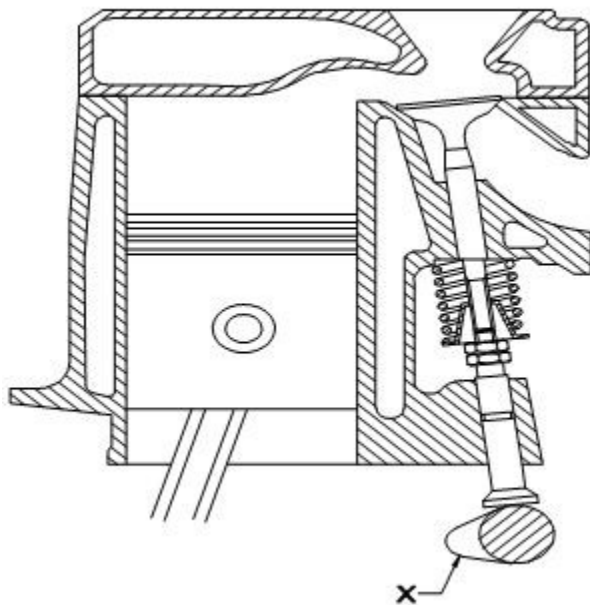

- (A) Cam lobe



- (B) Tappet
- (C) Valve seat
- (D) Rocker arm

Correct Answer : A

(36). What is the name of the part marked as 'x'?

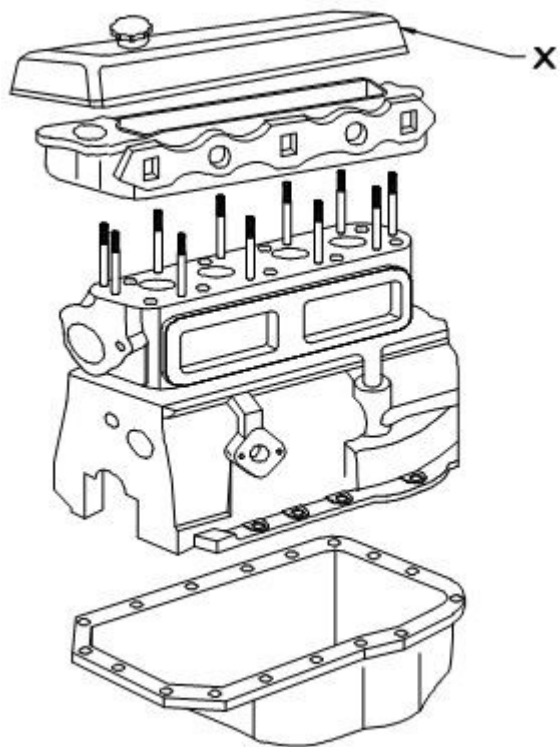

- (A) Valve door cover
- (B) Cylinder head
- (C) Engine block
- (D) Oil pan

Correct Answer : A

(37). What is the name of the part marked as 'X'?

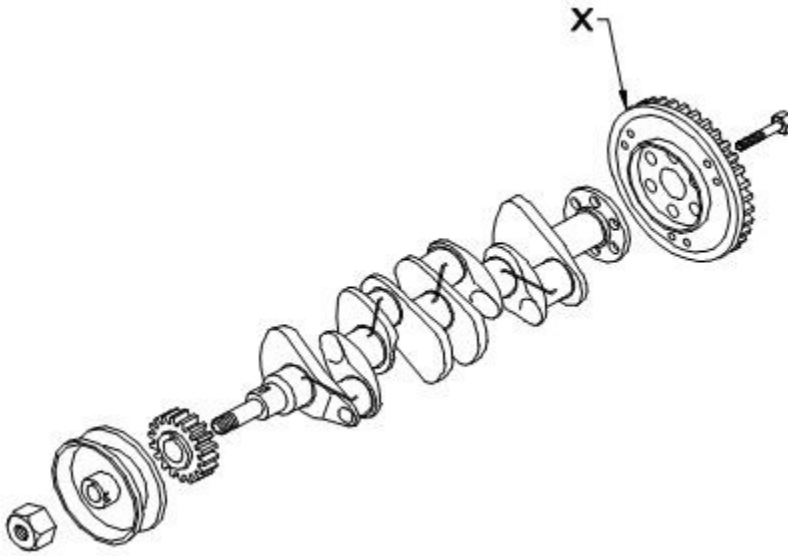

- (A) Drive product
- (B) Vibration damper
- (C) Fan pulley
- (D) Fly wheel

Correct Answer : D

(38). What type of load applied to connecting rod big end bearing?

- (A) Radial load only
- (B) Radial and thrust loads
- (C) Axial and radial loads
- (D) Axial load only

Correct Answer : B

(39). What type of bearing fitted in the connecting rod big end?

- (A) Needle bearing
- (B) Ball bearing
- (C) Taper roller bearing
- (D) Shell bearing

Correct Answer : D

(40). What is the material of cylinder block?

- (A) Cast iron
- (B) Bronze
- (C) Brass
- (D) Zinc alloy

Correct Answer : A

(41). What is the type of hardening done on crank shaft?

- (A) Induction hardening
- (B) Case hardening
- (C) Flame hardening
- (D) Surface hardening

Correct Answer : A

(42). Where the bush bearing preferred?

- (A) Connecting rods
- (B) Fly wheel and water pumps
- (C) Differential and wheel hub

(D) Gear boxes

Correct Answer : A

(43). Which is joining piston and connecting rod?

(A) Gudgeon pin

(B) Rocker arm

(C) Cam shaft

(D) King pin

Correct Answer : A

(44). Which is connected with piston through piston pin?

(A) Gudgeon pin

(B) Connecting rod

(C) Cam shaft

(D) Rocker arm

Correct Answer : B

(45). What is the name of part marked as 'X' in the figure?

(A) Locking lip

(B) Oil groove

(C) Lip slot

(D) Notch

Correct Answer : A

(46). What is the name of the tool?

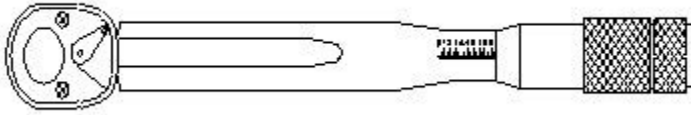

- (A) Dial type torque wrench
- (B) Scale type torque wrench
- (C) Ratchet type torque wrench
- (D) Torsion has type torque wrench

Correct Answer : B

(47). Which stroke inlet Valve open in four stroke engine?

- (A) Suction
- (B) Compression
- (C) Power stroke
- (D) Exhaust

Correct Answer : A

(48). Which load taken by the roller bearing?

- (A) Radial load
- (B) Axial load
- (C) Thrust load
- (D) Radial and axial load

Correct Answer : A

(49). What is ovality of a bore?

- (A) Difference in dia measured top to bottom
- (B) Difference in dia thrust to non thrust side of cylinder
- (C) Difference in dia measured only at top
- (D) Difference in dia measured only at bottom

Correct Answer : B

(50). When it is required to coincide the mark with timing gears?

- (A) During assembling water pump
- (B) During assembling oil pump
- (C) During assembling cam shaft
- (D) During assembling radiator

Correct Answer : C

www.itieexamyt.net